



# TOWN OF VIENNA, VIRGINIA DEPARTMENT OF PUBLIC WORKS

## INDEX OF SHEETS

Sheet No. 1	Title Sheet
Sheet No. 1A - 1B	NOT USED
Sheet No. 1C **	Standard Fairfax County General Notes
Sheet No. 1D **	Standard Fairfax County Utility General Notes
Sheet No. 1E	Right of Way Data Sheet
Sheet No. 1F - 1F(1)	Survey Control Data Sheet
Sheet No. 1G - 1G(1)	Construction Alignment Data Sheet
Sheet No. 1H - 1I	NOT USED
Sheet No. 1J	TMP/SOC General Notes
Sheet No. 1K	TMP/SOC Phase 1 Sta.25+25 to 33+00
Sheet No. 1K(1)	TMP/SOC Phase 2 Sta.25+25 to 33+00
Sheet No. 1L - 1L(2)	Erosion & Sediment Control Plan Notes and Details
Sheet No. 1M	Erosion & Sediment Control Plan: Phase 1
Sheet No. 1N	Erosion & Sediment Control Plan: Phase 2
Sheet No. 1o	NOT USED
Sheet No. 1P	Tree Survey
Sheet No. 2	NOT USED
Sheet No. 2A	Typical Sections
Sheet No. 2B - 2I	NOT USED
Sheet No. 2J	Project Data Sheet
Sheet No. 2J(1)	SWM Detention Exception Request
Sheet No. 2K	Existing Drainage & Sanitary Descriptions, Proposed Drainage Descriptions
Sheet No. 2K(1)	Existing Drainage Map (Phase 1 & Phase 2)
Sheet No. 2K(2)	Proposed Drainage Map (Phase 1 & Phase 2)
Sheet No. 2K(3) - 2K(5)	Storm Computations for Outfalls in Fairfax County
Sheet No. 2K(6) - 2K(8)	Storm Computations for Outfalls in Town of Vienna
Sheet No. 2K(9)	Drainage, SWM, and Outfall Narratives (Phase 1 & Phase 2)
Sheet No. 2K(9A)	Drainage, SWM, and Outfall Narratives (Phase 1 & Phase 2 Continued)
Sheet No. 2K(10)	Existing & Proposed Outfall Maps and Outfall Analysis Summary Table (Phase 1 & Phase 2)
Sheet No. 2K(10a)	Outfall Computations
Sheet No. 2K(11) - 2K(11b)	Water Quality Calculations - Vienna
Sheet No. 2K(11c) - 2K(11d)	Water Quality Calculations - Fairfax
Sheet No. 2K(12) - 2K(14)	Storm Sewer Profiles
Sheet No. 2K(15)	Culvert Computation
Sheet No. 3	Plan Sheet Sta.10+00 to 17+00 (For Information Only)
Sheet No. 4	Plan Sheet Sta.17+00 to 24+00 (For Information Only)
Sheet No. 5	Plan Sheet Sta.24+00 to 31+00 (For Information Only)
Sheet No. 6	Plan Sheet Sta.25+25 to 33+00
Sheet No. 6A	Profile Sheet Sta.26+00 to 33+00 & Private Entrances; Sta.28+69
Sheet No. 7	Signage Plan Sta.25+75 to 33+00
Sheet No. 8	Pavement Marking Plan Sta.25+75 to 33+00
Sheet No. XI thru XIII	NOT USED
Sheet No. XI4 thru XI7	Old Courthouse Road (Route 677) Cross Sections

\*\* Sheets not included with this submission.

## MAINTENANCE LEGEND:

- XXX-FAIRFAX COUNTY  
348 LF-6' CONC. SIDEWALK
- 0 LF-TRAIL
- 0 EA-BMP FACILITIES

DESIGN FEATURES RELATING TO CONSTRUCTION OR TO REGULATION AND CONTROL OF TRAFFIC MAY BE SUBJECT TO CHANGE AS DEEMED NECESSARY BY THE VIRGINIA DEPARTMENT OF TRANSPORTATION.

THIS PROJECT IS TO BE CONSTRUCTED IN ACCORDANCE WITH THE DEPARTMENT'S:

- 2016 ROAD AND BRIDGE SPECIFICATIONS,
  - 2016 ROAD AND BRIDGE STANDARDS,
  - 2009 MANUAL ON UNIFORM TRAFFIC CONTROL DEVICES (MUTCD),
  - 2011 VIRGINIA SUPPLEMENT TO THE MUTCD,
  - 2011 VIRGINIA WORK AREA PROTECTION MANUAL,
- AND AS AMENDED BY CONTRACT PROVISIONS AND THE COMPLETE ELECTRONIC .PDF VERSION OF THE PLAN ASSEMBLY.

ALL CURVES ARE TO BE SUPERELEVATED, TRANSITIONED AND WIDENED IN ACCORDANCE WITH STANDARD IC-5.11U, EXCEPT WHERE OTHERWISE NOTED.

FUNCTIONAL CLASSIFICATION			
OLD COURTHOUSE ROAD, ROUTE 677 (VIENNA ROUTE 6668)			
URBAN MINOR ARTERIAL (GS-6) - ROLLING			
Fr:	Rte.724, Creek Crossing Rd	East City Line for City of Vienna	East City Line for City of Vienna
To:	North City Line for City of Vienna	Rte.123, Chain Bridge Road	West City Line for City of Vienna
AADT (2014)	6,900	10,000	9,800
DHV	1,029	1,240	1,157
D (%) (design hour)	80.9	82.8	77.7
T (%) (design hour)	0	0	0
DESIGN V (MPH)	25	25	25
POSTED V (MPH)	25	25	25

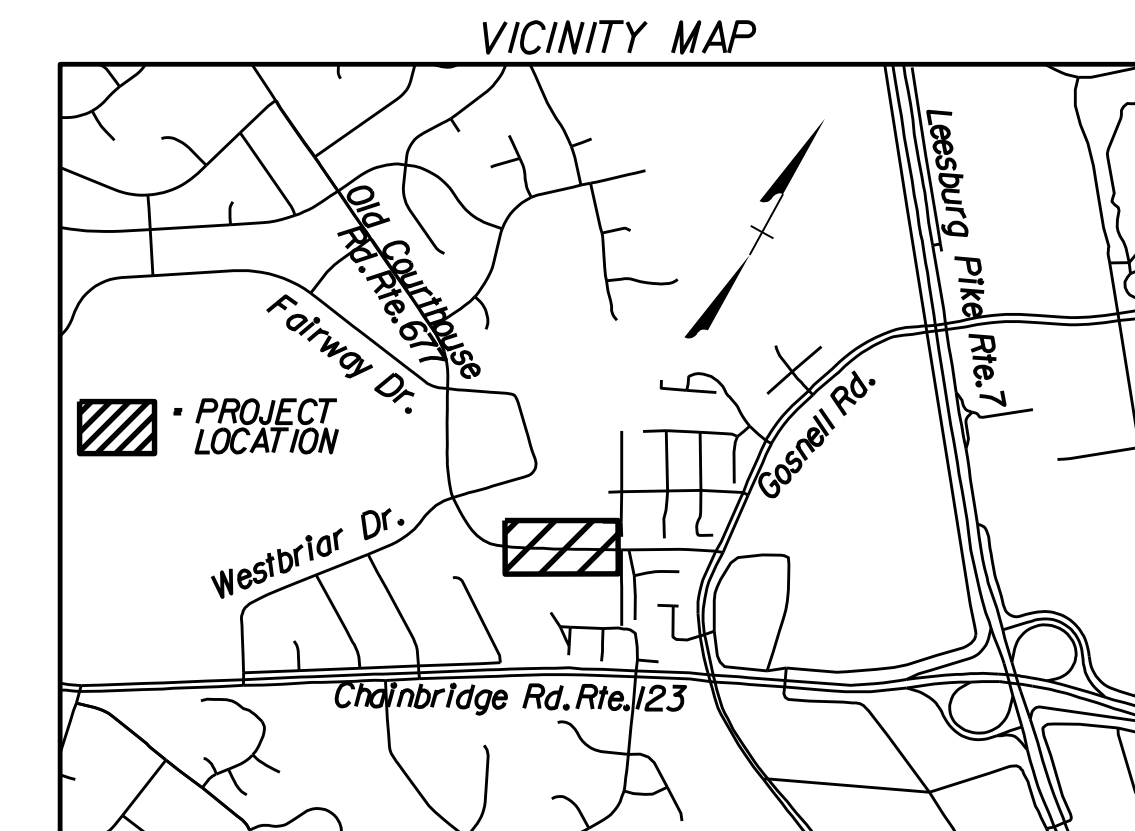

FINAL PLAN  
JUNE 2018

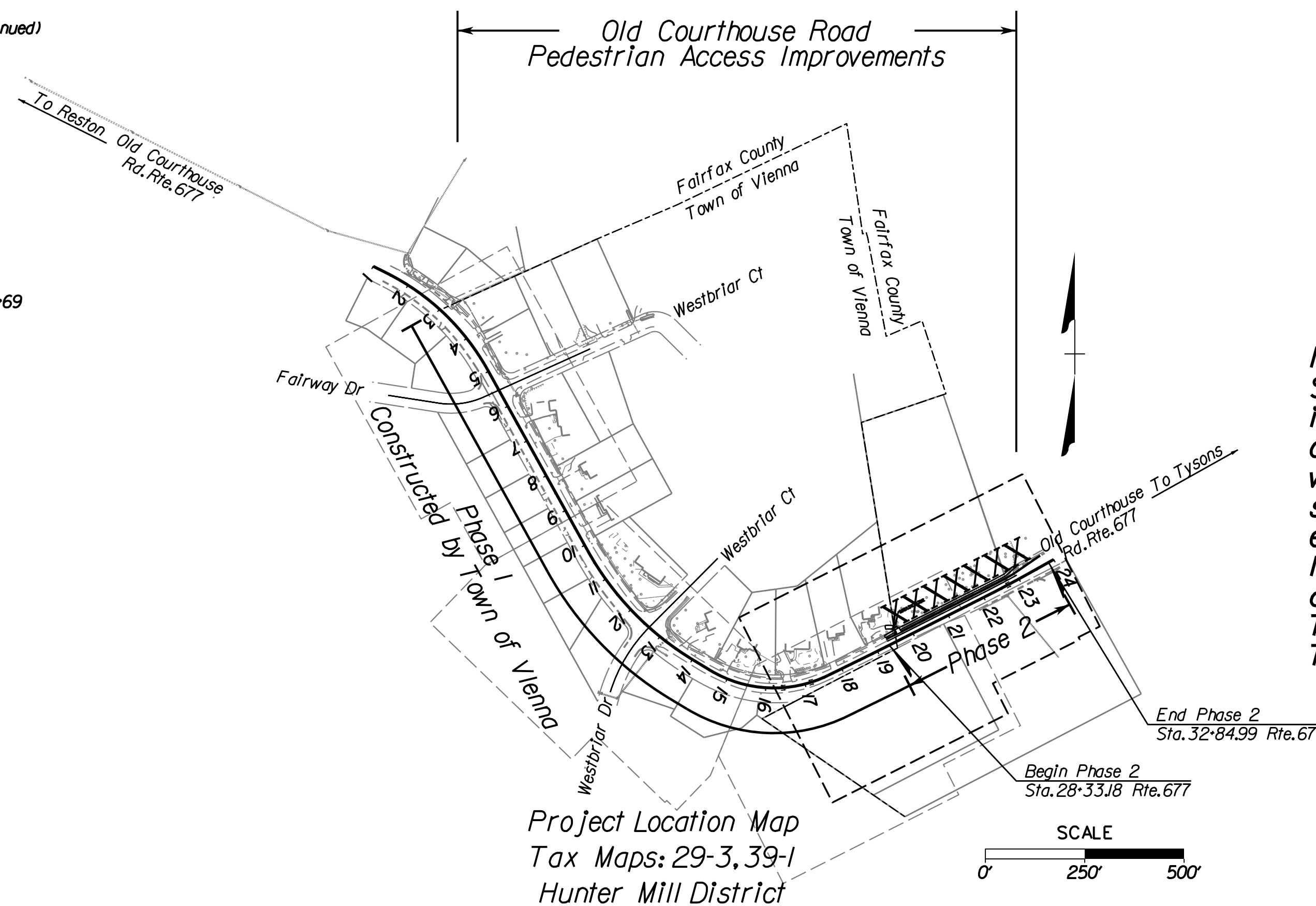

Note: This plan is for Phase 2 elements only. Storm Water Management/Hydraulics have been included for both Phase 1 and Phase 2 for continuity and clarity. ALL Phase 1 elements are within the Town of Vienna and subject to Town's separate locality approvals only. ALL Phase 1 elements are shown for information only and Town locality approval is provided separately. Locality approval for Phase 1 is shown on Sheet 2K(9A). Town of Vienna maintains all roadways within Town limits.

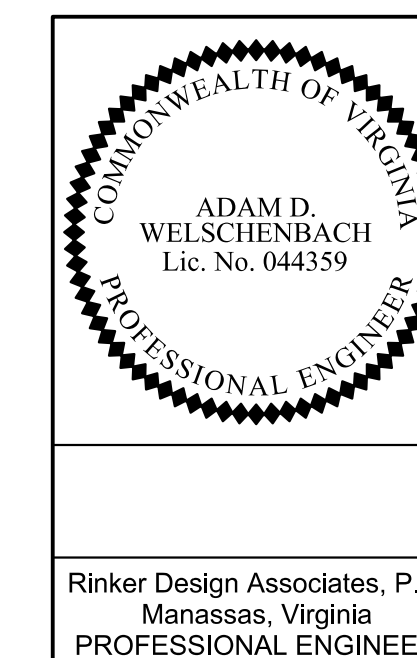

Rinker Design Associates, P.C.  
Manassas, Virginia  
PROFESSIONAL ENGINEER

# OLD COURTHOUSE ROAD PEDESTRIAN ACCESS IMPROVEMENTS PHASE 2 (OUTSIDE TOWN OF VIENNA LIMITS)

FINAL PLANS AUTHORIZED FOR CONSTRUCTION	
DIRECTOR, TOWN OF VIENNA DEPARTMENT OF PUBLIC WORKS	DATE
SHEET 1	

PROJECT MANAGER Michael Gallagher, Town of Vienna (703) 255-6389  
SURVEYED BY Rinker Design Assoc., P.C. (703) 368-7373 (2011)  
DESIGN SUPERVISED BY Adam D. Welschenbach, P.E., Rinker Design Assoc., P.C. (703) 368-7373  
DESIGNED BY Adam D. Welschenbach, P.E., Rinker Design Assoc., P.C. (703) 368-7373

OLD COURTHOUSE ROAD PEDESTRIAN ACCESS IMPROVEMENTS PH.2  
FINAL PLAN - JUNE 2018